



- 楔形四爪中實夾頭。
- 主爪可單獨手動調整行程，以利工件求心。
- 防切屑及防水設計，特別適合使用於立式車床。
- WEDGE-HOOK type 4-jaw high speed power chuck.
- With manual radial setting of master jaws for the workpiece centering.
- Sealed against swarf, chips and coolant, suitable for vertical lathe.

4V-40 A20
4V-50 A20
4V-63 A20
Refer to Fig.A
參閱圖A

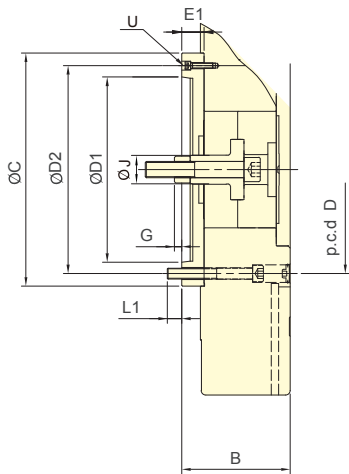
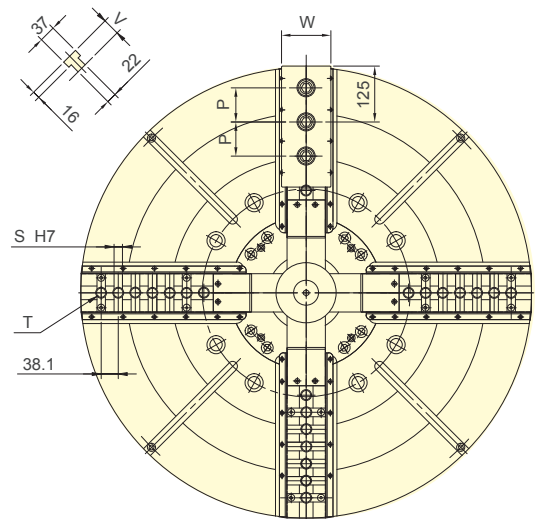
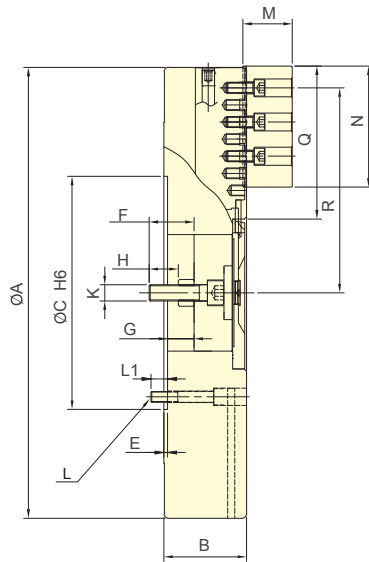

Fig.A
圖A



保留規格修改的權利
Subject to technical changes

技術規格 SPECIFICATIONS

型號	楔心行程	爪行程 (直徑)	夾持直徑 Chuck Dia.		容許油壓缸 推力	最大夾持力	最高迴轉數	I	重量	適用迴轉缸	最大使用壓力
Model	Plunger stroke	Jaw stroke (Dia.)	最大 Max.	最小 Min.	Max. D.B. pull	Max. Clamping force	Max. speed	Moment of inertia	Weight	Matching cyl.	Max. pressure
	mm	mm	mm	mm	kN (kgf)	kN (kgf)	min ⁻¹ (r.p.m.)	kg·m ²	kg		MPa (kgf/cm ²)
4V-40 A20	57	46+(60)	1005	380	180(18350)	320(32620)	500	70 94	620 680	RK-250	4.2(42)
4V-50 A20	57	46+(60)	1250	600	180(18350)	320(32620)	450	222 224	1130 1180	RE-250	4.2(42)
4V-63 A20	60	48+(80)	1600	600	200(20390)	360(36700)	340	565	1800	RE-A250 RE-L250	4.6(46)

外型尺寸 DIMENSIONS

Model	A	B	C	D	D1	D2	E	E1	F	G max.	G min.	H	J	K
4V-40 A20	1005	184 226	520	463.6	412.78	463.6	8	50	190	123 73	66 16	65	65	M36x4
4V-50 A20	1250	184 226	520	463.6	412.78	463.6	8	50	190	123 73	66 16	65	65	M36x4
4V-63 A20	1600	240	720	647.6	412.78	463.6	8	50	218	131	71	65	65	M36x4

Model	L	L1	M	N	P	Q	R max.	R min.	S	T	U	V	W
4V-40 A20	M24	37	110	270	76.2	295	457	404	6~19.03	7~M24	3~M12	42	84
4V-50 A20	M24	37	110	270	76.2	416	563	510	9~19.03	9~M24	3~M12	42	84
4V-63 A20	M30	46	110	270	76.2	540	738	674	12~19.03	13~M24	-	42	110

1. 紅色數據為 4V-A 型之寸法 (The dimensions and the specifications of 4V-A type are in red data.)